

DF sheet B1-B2

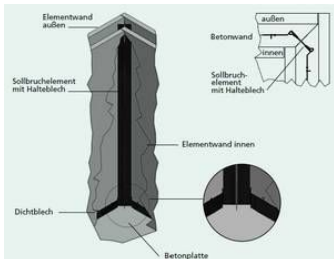
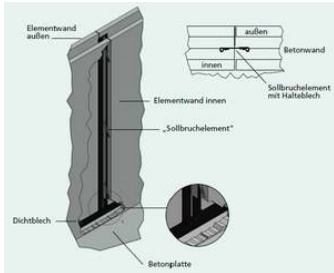
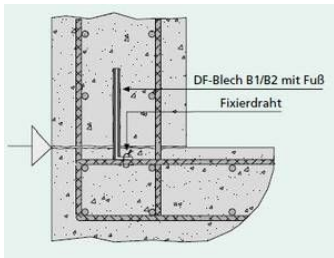
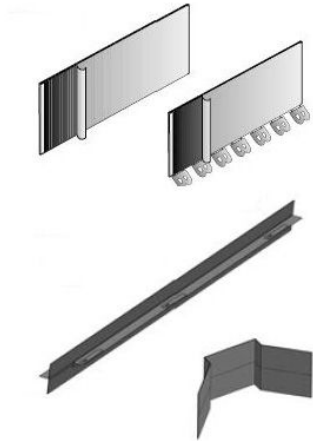

DF metal waterstops are metal sheets with a special bituminous coating for sealing horizontal and vertical construction joints.

DF joint plate with retaining plate for vertical element wall joints.

DF joint plate with retaining plate for vertical corner element wall joints.

Applications, features, properties and benefits

Advantages:

Full-surface bituminous special coating

Safe and quick sealing of all construction joints with continuous reinforcement

No complex concrete upstands necessary

DF sheet metal B1/B2 with foot (B-shaped as a 90° contact angle) for high stability and easy tying

Minimum embedment depth of the metal sheet in concrete ≥ 3 cm

Sheet metal joints are secured by means of butt clamps

Minimum overlap of sheet metal joints ≥ 10 cm

No corner pieces required as the sheets can be bent and adjusted without tools

Two-piece siliconized film for optimal protection of the coating

DF sheet B1-B2

| Article description | Title of variant | Packaging piece/ metre/ metre by the metre/ bucket/ bag/ bundle/ box/ can | Weight kg/metre | Weight kg/piece |
|---------------------|--|--|--------------------|--------------------|
| 87401150 | DF sheet B1 (coated on one side) 150 x 2000 mm | 100m/box | 0,980 | |
| 87402150 | * DF sheet B2 (coated on both sides) . 150 x 2000 mm | 100m/box | 1,150 | |
| 87402250 | * DF sheet B2 roll (coated on both sides) . 20 m | 20m / roll | | 0,880 |
| 87600011 | Fixation bracket | 100 pieces | | 0,082 |
| 87600020 | Shock clamp | 100 pieces | | 0,007 |
| 44390162 | Spring cotter pin D=4mm galvanised . DIN 11024 (as butt clip) | 1 pieces | | 0,016 |
| 87401160 | DF sheet B1 with foot (coated on one side) 150 x 2000 mm | 1 piece | 1 | |
| 87402160 | * DF sheet B2 with foot (coated on both sides) 150 x 2000 mm | 100m/box | 1,250 | |
| 87402180 | DF nominal crack element B2 straight . element length 2,50 meter | linear metre | 1,540 | |
| 87402202 | DF corner element B2 | 1 piece | | 0,450 |